

# Multi-range Analog Timers

## Accessory

DIN Rail 8-PIN Socket (Time-S1-08)

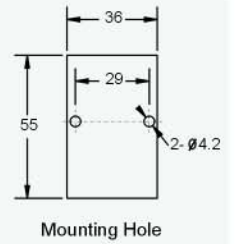
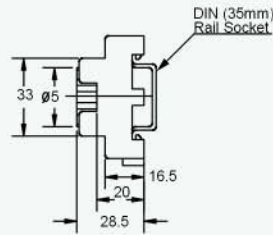
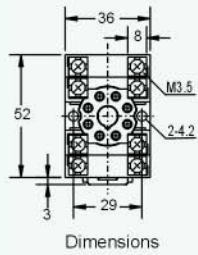

DIN Rail 8-PIN Socket (Time-S2-08)

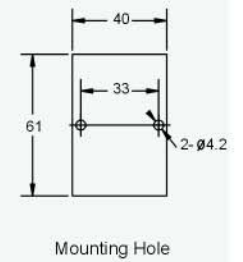
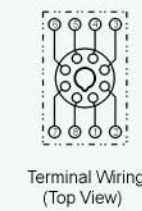
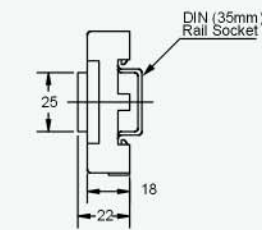
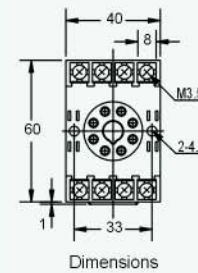
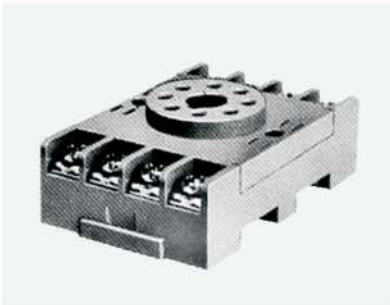

DIN Rail 8-PIN Socket (Time-S3-08)

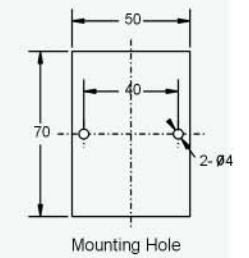
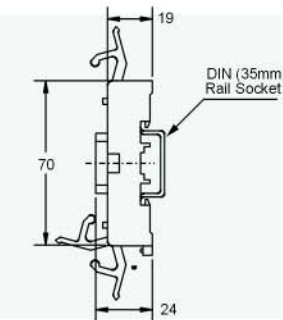
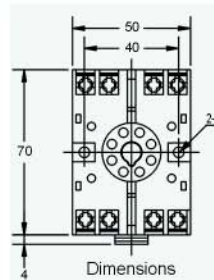

DIN Rail 11-PIN Socket (Time-S1-11)

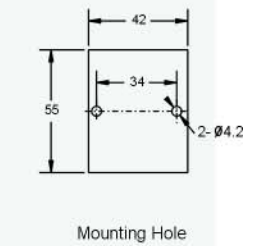
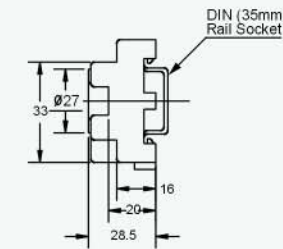
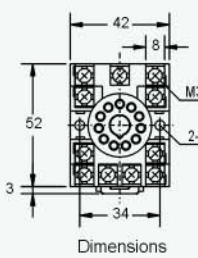

DIN Rail 11-PIN Socket (Time-S2-11)

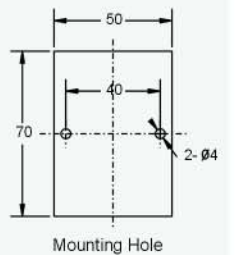
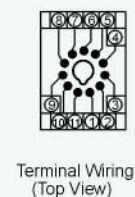
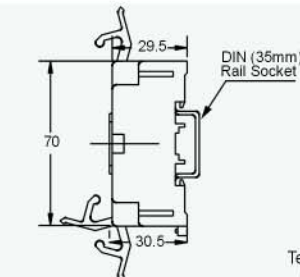
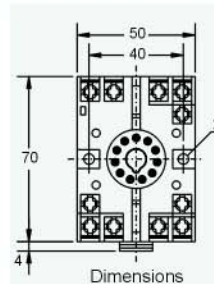

# Multi-range Analog Timers

## Accessory

### 8-PIN Cap (Time-R1-08)

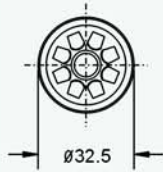

Dimensions

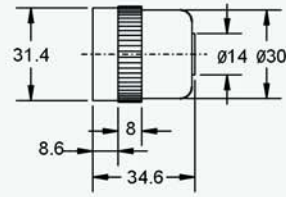

Terminal Wiring  
(Top View)

### 11-PIN Cap (Time-R2-08)

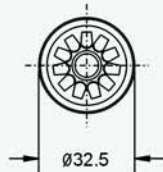

Dimensions

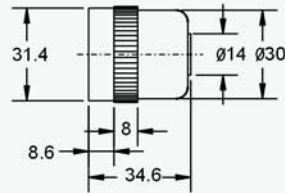

Terminal Wiring  
(Top View)

### T48A Mounting Frame (Time-T48-F1)

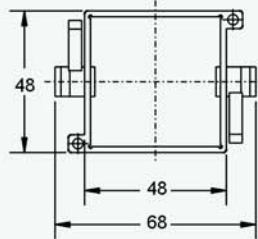

Dimensions

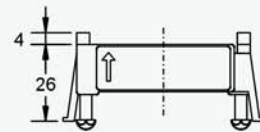

### T36A Mounting Frame (Time-T36-F1)

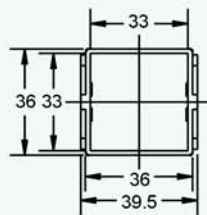

Dimensions

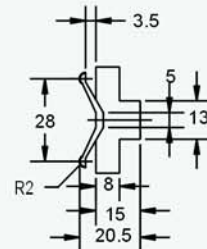

### T29A Mounting Frame (Time-T29-F1)



#### Mounting Rails (Applicable For DIN and IEC Standards) (Time-Din-35)

